

A-dec Self-Contained Water System

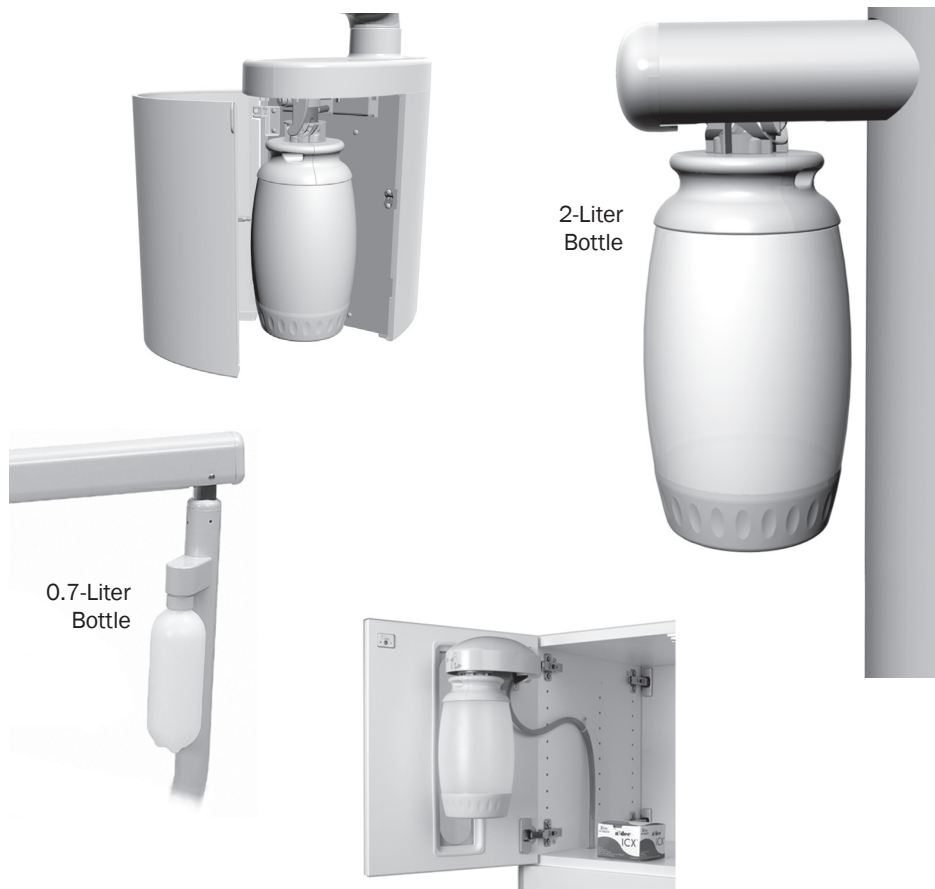

The self-contained water system supplies water to handpieces, syringes, and the cuspidor cupfill. The system includes a 2- or 0.7-liter water bottle that mounts to the delivery arm, support center, or cabinet. This system provides an easy way for you to control the quality of your treatment water.



WARNING Use only A-dec self-contained water bottles. Do not use other bottles, including glass or plastic beverage bottles. Do not use damaged bottles. These can pose a serious safety hazard while pressurized.

A-dec plastic water bottles cannot withstand heat sterilization. Attempting to do so will damage the bottle and your sterilizer.



CAUTION Use caution when using the self-contained water system with accessories that require an uninterrupted water supply (e.g., scalers), as these could get damaged without a continuous water source.

Do not use saline solutions, mouth rinses, or any chemical solutions not specified in this guide in your A-dec self-contained water system. These may damage the system components and cause equipment failure.

Water Quality



How to Choose Treatment Water

The correct water to use in the A-dec self-contained water system depends on the quality of your municipal water. It's important to choose a source that consistently provides good water quality. For guidance, refer to the regulations specific to your location.

- **Tap Water** – If you have confidence in the quality of your municipal water supply, consider using tap water in your self-contained water bottle.
- **Bottled Water** – If you have concerns about the quality of your municipal water supply, use bottled water from a commercial source.
- **Softened Water** – In areas with hard water, greater than 200 mg/L as calcium carbonate (11.7 grains per gallon, 2.0 mmol/L), A-dec recommends the use of a water softener to prevent the buildup of mineral deposits that may impact the functionality of your delivery system.

How to Maintain Water Quality

A-dec's recommendation for waterline maintenance is based on continuous use of the A-dec ICX® waterline treatment tablet in conjunction with regular dental unit water monitoring and shock treatment. Your shock treatment protocol should include an anti-microbial product registered with the U.S. Environmental Protection Agency (US EPA). If you are located outside the USA, contact your authorized A-dec dealer for product recommendations that are compatible with A-dec equipment.



IMPORTANT Follow the instructions that appear on the ICX packaging. For more information on waterline maintenance, see the *Waterline Maintenance Guide* (p/n 85.0983.00).

Water Bottle Removal and Installation

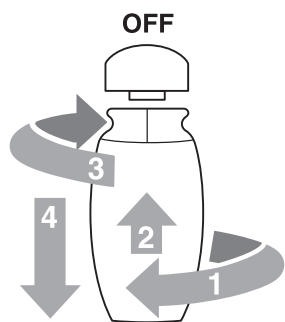

2-Liter Bottle

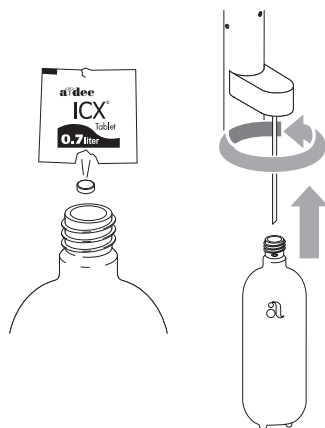
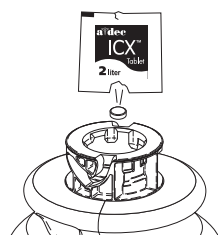

0.7-Liter Bottle

Follow these procedures to properly remove, refill, and install an A-dec self-contained water bottle:

1. Use the master toggle to turn off the system.
2. Turn the bottle counterclockwise until the air seal breaks.
3. Remove the bottle:
 - **2-liter bottle** – push the bottle up while turning it counterclockwise, then pull down to remove.
 - **0.7-liter bottle** – turn the bottle counterclockwise to remove.
4. Empty any remaining water from the bottle.
5. Wash your hands with soap and water, and wear new gloves before handling, filling, and installing the water bottle.
6. Drop an ICX tablet into the bottle and fill with treatment water.



IMPORTANT Follow the instructions that appear on the ICX packaging.

7. Install the bottle:
 - **2-liter bottle** – align it with the water bottle receptacle, then push up and turn clockwise.
 - **0.7-liter bottle** – align it with the water bottle cap, making sure that the pick-up tube extends straight down into the bottle. Screw the bottle onto the cap until it is secure.



CAUTION Do not overtighten the water bottle or you may damage the components. It is normal to hear a pressurization sound after the system is turned on.

8. Turn on the system. Air can be heard filling the bottle.
9. Operate the syringe and handpieces to clear any air from the water system.

Specifications

Capacity

2-liter bottle: 1.953 liters
0.7-liter bottle: 0.652 liters

Recommended Operating Air Pressure

50 – 125 psi



IMPORTANT For electrical specifications, identification of symbols, and other regulatory requirements, see the *Regulatory Information, Specifications, and Warranty* document (p/n 86.0221.00), which is available in the Document Library at www.a-dec.com.



NOTE Specifications are subject to change without notice. Requirements may vary depending on your location. For more information, contact your authorized A-dec dealer.



A-dec Headquarters

2601 Crestview Drive
Newberg, Oregon 97132
United States
Tel: 1.800.547.1883 within USA/CAN
Tel: +1.503.538.7478 outside USA/CAN
Fax: 1.503.538.0276
www.a-dec.com

A-dec Australia

Unit 8
5-9 Ricketty Street
Mascot, NSW 2020
Australia
Tel: 1.800.225.010 within AUS
Tel: +61.(0).2.8332.4000 outside AUS

A-dec China

A-dec (Hangzhou) Dental Equipment Co., Ltd.
528 Shunfeng Road
Qianjiang Economic Development Zone
Hangzhou 311106
Zhejiang, China
Tel: +1.503.538.7478

A-dec United Kingdom

EU Authorized Representative
Austin House, 11 Liberty Way
Nuneaton, Warwickshire CV11 6RZ
England
Tel: 0800.ADEC.UK (2332.85) within UK
Tel: +44.(0).24.7635.0901 outside UK

Warranty

Warranty information is provided in the *Regulatory Information, Specifications, and Warranty* document (p/n 86.0221.00), which is available in the Document Library at www.a-dec.com.



86.0609.00 Rev G
Copyright 2014 A-dec Inc.
All rights reserved.